

Traditional Roots-Type Pressure Weighted Relief Valve

Traditional Roots-Type weighted relief valves are designed for use in positive displacement blower applications. NPT connection sizes of 1", 1.5", and 2.5" are available supporting relief set point pressures of 0.5 PSIG to 15 PSIG.

Stackable 0.5 PSI weighted plates allow for simple adjustment to relief valve set pressure when added to or removed from the 0.5 PSI base valve body. Automatic reseating of the valves ensures that systems will resume normal operation once any imbalance events have been resolved.

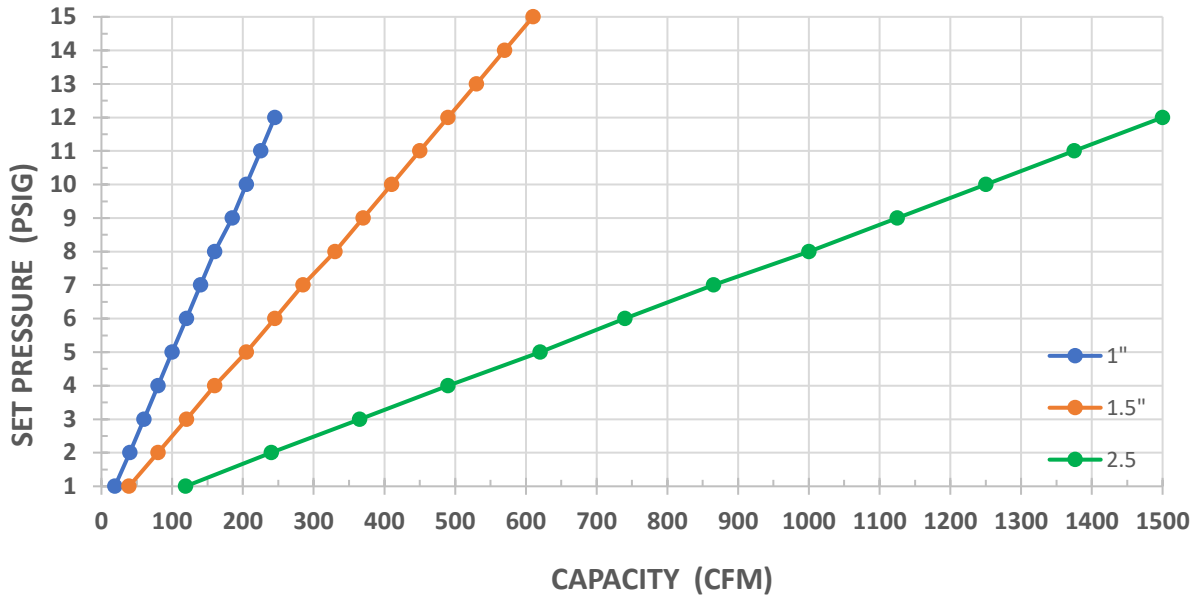

DIMENSIONS

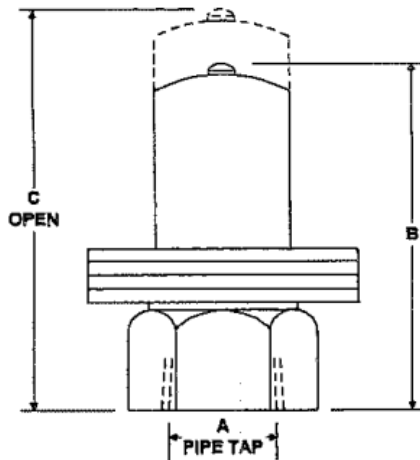
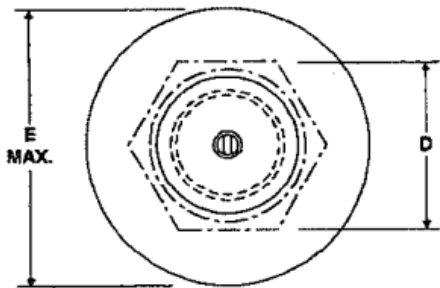

SIZE	A	B	C	D	E	Wt. (Lbs.)
1"	1.0" FPT	4.19	4.75	2.00	6.00	5
1-1/2"	1.5" FPT	5.81	6.44	2.63	8.13	10
2-1/2"	2.5" FPT	7.63	8.88	3.63	9.88	25

All dimensions in inches



TOMLIN
Equipment Co.



INDUSTRIAL EQUIPMENT • MAJOR STOCKING DISTRIBUTOR
ENGINEERING • SALES • SERVICE • PARTS

242 POPLAR STREET • P.O. BOX 8053 • TOLEDO, OH 43605 • (419) 691-3571 • FAX (419) 691-1928
5091 WEST 164TH STREET • CLEVELAND, OHIO 44142 • (216) 265-0666 • FAX (216) 265-0667
1-800-882-1992 (OHIO TOLL FREE) 1-855-691-0621 (MICHIGAN TOLL FREE)

www.tomlinequip.com